

GENERAL SPECIFICATIONS		REVISIONS				
IGNITION TYPE	WASTED SPARK	ZONE	REV.	DESCRIPTION	DATE	APPROVED
MAX. INPUT RPM	3500 RPM	ALL	PT-1	PROTOTYPE 1	04/14/2017	RVC
OPERATING TEMPERATURE RANGE	-38°C TO +107°C	ALL	PT-2	PROTOTYPE 2	06/01/2017	RVC
VOLTAGE INPUT RANGE	8.5 - 30 Vdc	ALL	IR	INITIAL RELEASE FOR PRODUCTION	05/21/2018	RVC
OPERATING POWER REQUIREMENTS @ 2700 RPM	1.00±0.2 A @ 14 Vdc 0.50±0.2 A @ 28 Vdc	ALL	A	ECO 19-001	03/25/2019	RVC
MANIFOLD PRESSURE INPUT RANGE	5 - 45 inHg	ALL	B	ECO 20-001	03/30/2020	RVC
TIMING ACCURACY	±2°	ALL	C	ECO 20-002	01/11/2021	RVC
BUILD	surefly_6_20120102_lyc_seed7269.pof	ALL	D	ECO 21-004	03/01/2021	RVC
CHECKSUM	00572E30	ALL	E	ECO 22-001	01/20/2022	RVC
		ALL	F	ECO 22-002	04/01/2022	RVC
		ALL	H	ECO 24-001	08/01/2024	RVC

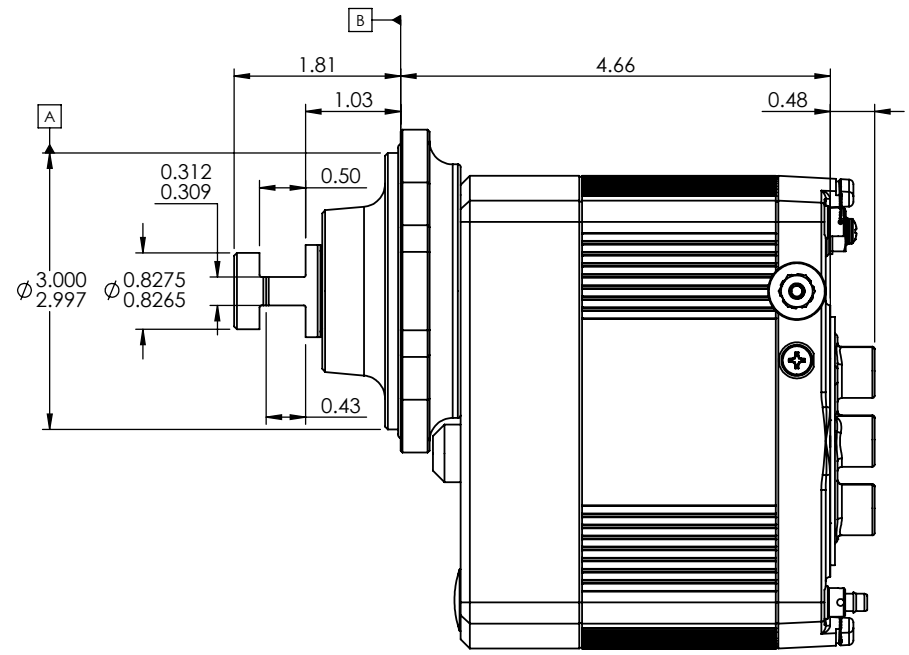
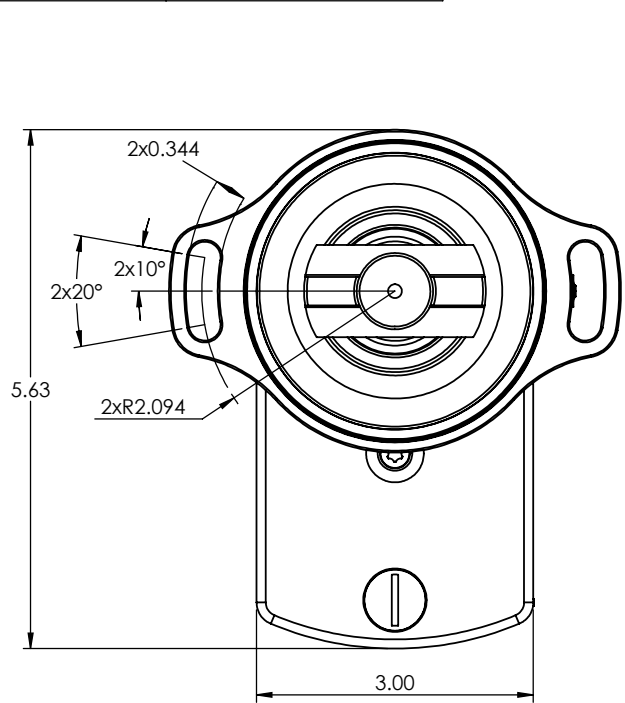

DIP SWITCH SETTINGS						FIRING ORDER				
ENGINE TIMING	IGNITION ROTATION	TIMING OPTION	DIP SWITCH				LED CODE ON=SHORT OFF=LONG 12/SECOND =ERROR	TIMING SCHEDULE	LEFT ROTATION (L)(LN)	RIGHT ROTATION (R)(RN)
			1	2	3	4			A-B-C-D-E-F	A-F-E-D-C-B
20°	LEFT (L)(LN)	VARIABLE	OFF	OFF	OFF	OFF	----	A-20		
	LEFT (L)(LN)	FIXED	OFF	ON	OFF	OFF	----	F-20		
	RIGHT (R)(RN)	FIXED	ON	ON	OFF	OFF	----	F-20		
23°	LEFT (L)(LN)	VARIABLE	OFF	OFF	OFF	ON	----	A-23		
	LEFT (L)(LN)	FIXED	OFF	ON	OFF	ON	----	F-23		
25°	LEFT (L)(LN)	VARIABLE	OFF	OFF	ON	OFF	----	A-25		
	LEFT (L)(LN)	FIXED	OFF	ON	ON	OFF	----	F-25		
	RIGHT (R)(RN)	VARIABLE	ON	OFF	ON	OFF	----	A-25		
	RIGHT (R)(RN)	FIXED	ON	ON	ON	OFF	----	F-25		

**SureFly**  
Granbury, Texas

**6 CYLINDER LYCOMING IGNITION**

SCALE:	MATERIAL:	FINISH:
1:2	N/A	N/A
DIMENSIONS IN INCHES UNLESS OTHERWISE SPECIFIED		DATE:
TOLERANCES:		05/21/2018
ANGLES	DRAWN BY:	SHEET:
±1°	R. CONDY	1/1
0.X ±0.050	PART NO:	REV:
0.XX ±0.030	<b>SIM6L</b>	<b>H</b>
0.XXX ±0.010		